

FRONT VIEW

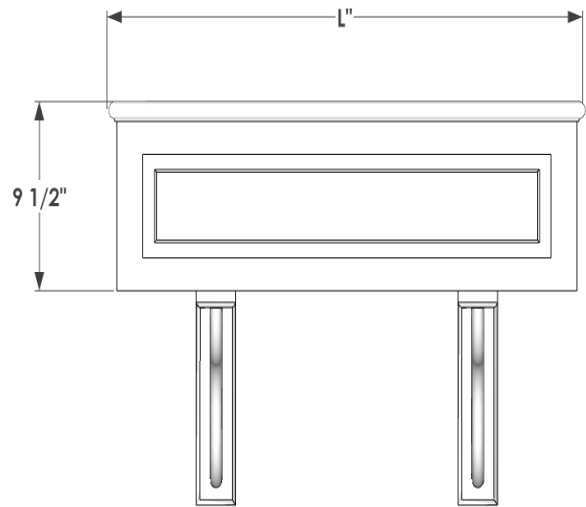

SIDE VIEW

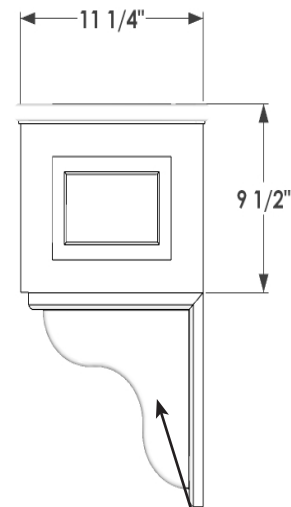

| L SIZE |
|--------|
| 24" |
| 30" |
| 36" |
| 48" |
| 60" |
| 72" |

BACK VIEW

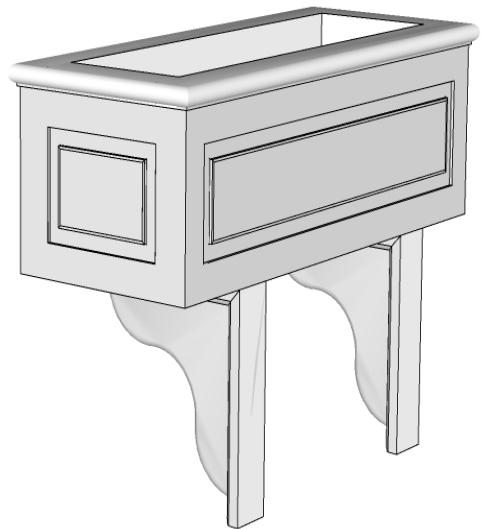

Pair of Brackets (2 pairs for 60" and 72" lengths)

| GENERAL NOTES |
|---|
| 1. Shelf Mount Brackets are Required for Wall Mounting Applications |
| 2. Framed style : W0-TRAD 24"-36" has 1 raised panel, 48"-72" has 2 raised panels |

|  6056 Corte Del Cedro, Carlsbad CA 92011 1-888-320-0626/service@plantersunlimited.com www.plantersunlimited.com | PRODUCT DESCRIPTION | | SKU | | ORDER NUMBER | CUSTOMER SIGNATURE |
|---|----------------------------|-------|--------|------|--------------|--------------------|
| | Framed Panel Cedar Planter | | W1-FPC | | | |
| | DIMENSIONS | COLOR | FINISH | REP: | DB: | DATE |
| | Natural Cedar | | | | | |

